

- PLAN NOTES:**
- DISCONNECT AND REMOVE EXISTING EXHAUST FAN. FIELD VERIFY EXACT LOCATION OF FAN.
 - DISCONNECT AND REMOVE EXISTING EXHAUST DUCT FROM BELOW BLEACHERS. REFER TO SHEET M103 FOR NEW DUCTWORK TO BE INSTALLED AND CONNECTED TO NEW EXHAUST GRILLES IN CEILING BELOW.
 - EXISTING OUTSIDE LOUVER TO REMAIN. DISCONNECT EXISTING DUCTWORK BELOW BLEACHERS. SEAL LOUVER OFF WITH PRE-FINISHED SHEET METAL NEXT TO LOUVER BLADES. FILL WALL CAVITY WITH RIGID INSULATION AND SEAL WITH SHEET METAL ON INTERIOR OF WALL. CONTRACTOR TO FIELD VERIFY EXISTING SIZE AND LOCATION OF EXISTING LOUVER.
 - EXISTING STEAM CONVECTOR, UNIT VENTILATOR, AND/OR UNIT HEATER TO REMAIN. PROTECT DURING CONSTRUCTION. ASSOCIATED EXISTING STEAM PIPING BELOW FLOOR TO REMAIN. REFER TO SHEET M002.
 - EXISTING WALL MOUNTED THERMOSTAT CONTROL DEVICE TO REMAIN. PROVIDE DURING CONSTRUCTION. MAINTAIN CONNECT TO EXISTING ELECTRONIC WIRING AND/OR PNEUMATIC CONTROL TUBING. CONTRACTOR TO FIELD VERIFY EXISTING CONDITIONS.
 - DISCONNECT AND REMOVE EXISTING STEAM UNIT VENTILATOR AND/OR STEAM CONVECTOR. REMOVE ALL ASSOCIATED STEAM PIPING AND OUTSIDE AIR DUCTWORK. REFER TO ARCHITECTURAL DRAWINGS FOR PATCHING OF EXISTING WALLS. REMOVE EXISTING STEAM PIPING DOWN THRU FLOOR. CONTRACTOR TO FIELD VERIFY EXACT SIZES AND LOCATIONS OF EXISTING EQUIPMENT AND PIPING.
 - DISCONNECT AND REMOVE EXISTING THERMOSTAT CONTROL FROM WALL. REMOVE ALL CONTROL WIRING BACK TO NEXT UP-STREAM J-BOX. FOR EXISTING PNEUMATIC CONTROLS, REMOVE CONTROL AND CAP TUBING IN WALL AIR TIGHT. CONTRACTOR TO FIELD VERIFY EXISTING CONDITIONS.
 - EXISTING OUTSIDE AIR LOUVER. REMOVE EXISTING PLYWOOD AND/OR SHEET METAL AND ALL IN-FILL MATERIAL FROM EXISTING LOUVER. REFER TO SHEET M103 FOR NEW DUCTWORK TO BE CONNECTED TO EXISTING LOUVER.
 - DISCONNECT AND REMOVE EXISTING THRU-THE-WALL A/C UNIT. DELIVER TO OWNER. REFER TO ARCHITECTURAL DRAWINGS FOR PATCHING OF WINDOWS.
 - EXISTING STEAM PIPING TO REMAIN. PROTECT DURING CONSTRUCTION AND COORDINATE INSTALLATION OF NEW ERV UNITS WITH PIPING. REFER TO SHEET M103 FOR NEW EQUIPMENT AND DUCTWORK TO BE INSTALLED.
 - EXISTING STORAGE SHELVES TO BE REMOVED BY OWNER. CONTRACTOR TO SCHEDULE WORK WITH OWNER.
 - EXISTING LOUVER TO REMAIN. DISCONNECT EXISTING DUCTWORK, SEAL LOUVER OFF WITH PRE-FINISHED SHEET METAL NEXT TO LOUVER BLADES. FILL WALL CAVITY WITH RIGID INSULATION. REFER TO ARCHITECT'S DRAWINGS FOR INTERIOR WALL PATCH. CONTRACTOR TO FIELD VERIFY EXISTING SIZE AND LOCATION OF EXISTING LOUVER.

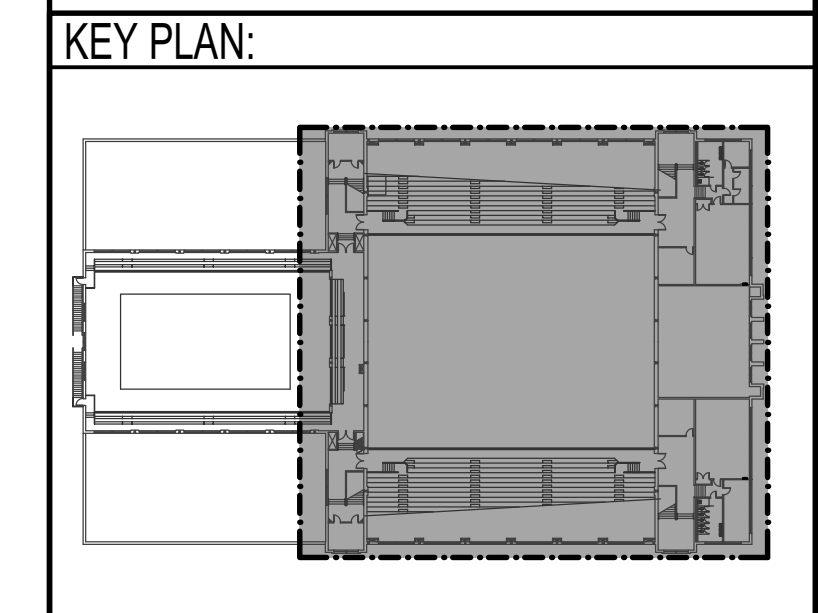

ORIGINAL DRAWING SIGNED BY: DWAYNE C. SUDWEEKS
 DATE ORIGINAL SIGNED: Feb 16, 2021
 ORIGINAL ON FILE AT ENGINEERED SYSTEMS ASSOCIATES
 1355 EAST CENTER, POCAATELLO, IDAHO 83201

PROFESSIONAL ENGINEER
 REGISTERED
 STATE OF IDAHO
 DWAYNE C. SUDWEEKS
 5762

Engineered Systems Associates
 1355 EAST CENTER
 POCAATELLO, IDAHO 83201
 PHONE: (208) 233-0501
 FAX: (208) 233-0529
 EMAIL: eso@engsystems.com
 ESA JOB NUMBER: 18050

BLD2009-00063
REVIEWED FOR CODE COMPLIANCE
This approval shall not be construed to be an approval of any violation of, or variance from, Idaho's adopted codes, standards, laws or rules applicable to this project.
 SEPARATE BUILDING PERMIT REQUIRED FOR CONSTRUCTION

CONTRACTOR SHALL VERIFY ALL DIMENSIONS & CONDITIONS SHOWN OR IMPLIED

DRAWING SCALE APPLIES TO 22' X 34' SHEET SIZE

REVISION DATE

DRAWN BY: M. JENSEN
 CHECKED BY: D. SUDWEEKS
 JOB NUMBER: 18467
 PROJECT DATE: FEBRUARY 2021

PROJECT: REED GYM HVAC UPGRADE
 IDAHO STATE UNIVERSITY
 DPW # 19227

SHEET TITLE:
 THIRD FLOOR MECHANICAL DEMOLITION PLAN

POCAATELLO, IDAHO

Myers Anderson
 Architecture
 Interior Design
 Landscape Architecture
 122 South Main Street Pocatello, Idaho 83204 Tel: (208) 232-3747 Fax: (208) 232-3782
 927 Main Street, Suite 300 • Evanston, Wyoming 82930 • Tel: (307) 789-0934

ASLA
 NCARB
 AIA

THIRD FLOOR MECHANICAL DEMO PLAN

SCALE: 3/32" = 1'-0" North